

TPV Series

Vertical multistage jockey pumps
60 Hz

PRODUCT CATALOGUE



VERTICAL MULTISTAGE PUMPS

Energy Saving & Low-Noise



Product Description

TPV is a low-noise, energy-saving multistage pump. It is built to ensure durability and easy operation, making it a reliable choice for many applications. Featuring a high-efficiency motor with IP55 class F protection, a techno-polymer impeller, and cast iron G20 thread suction and discharge ports, this pump is built to last. Plus, it includes quality NSK bearing and a wear-resistant mechanical seal. The compact and proportional design makes it a great option.

Applications

TPV can be used for household, irrigation, car wash, fire protection systems, air conditioning and pressure boosting in water networks.

Operating Data

- Flow: 0 - 48 m³/h
- Head: 0 - 224 m
- DN: 25 - 65 mm
- Medium: clean water or non-aggressive liquid (free of solids or fiber)
- Medium temperature: -10 ~ 120 °C
- Max. ambient temperature: -10 ~ 50 °C
- Max. working pressure: 25 bar

Motor

- Insulation Class: F
- Protection Class: IP55
- Continuous Service: S1
- Power: 1.1 - 11 kW
- Frequency: 60 Hz
- Voltage: 220/380/400/440 V
- Speed: 3500 rpm



Model Description

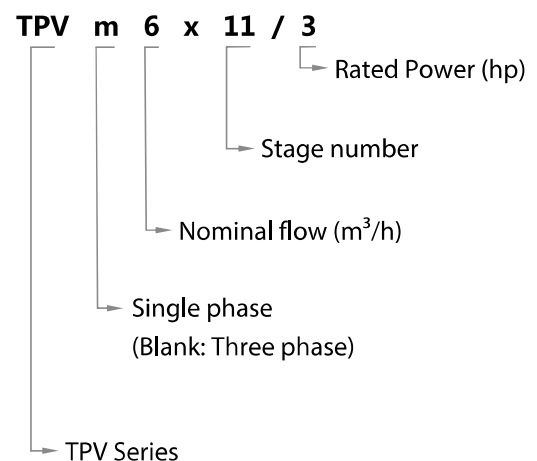

PRODUCT OVERVIEW

Reliable & Durable

Technical Data

60 Hz n=3500 1/min

MODEL	DN mm	Power kw hp		Q=DELIVERY																				
				us gpm	5	11	13	16	19	21	24	26	29	32	37	42	48	53	58	63	69	74	79	
				l/min	20	40	50	60	70	80	90	100	110	120	140	160	180	200	220	240	260	280	300	
				m ³ /h	1.2	2.4	3	3.6	4.2	4.8	5.4	6	6.6	7.2	8.4	9.6	10.8	12	13.2	14.4	15.6	16.8	18	
					H=Head (m)																			
TPV 4x4/1.5	25x25	1.1	1.5	52	49	46	44	41	39	37	33	30	27	23										
TPV 4x6/2	25x25	1.5	2	77	74	69	66	63	58	55	50	45	40	34										
TPV 4x8/3	25x25	2.2	3	104	99	92	88	84	78	73	66	60	53	45										
TPV 4x10/4	25x25	3	4	129	124	116	110	104	97	91	83	75	66	57										
TPV 4x13/5.5	25x25	4	5.5	168	161	150	143	136	126	119	108	97	86	74										
TPV 4x16/7.5	25x25	5.5	7.5	206	198	185	177	167	156	146	133	119	106	91										
TPV 6x3/1.5	32x32	1.1	1.5	40				36	35	33	31	30	28	26	22	17								
TPV 6x5/2	32x32	1.5	2	66				60	58	55	52	50	47	43	36	28								
TPV 6x7/3	32x32	2.2	3	92				85	81	78	73	70	66	61	51	40								
TPV 6x9/4	32x32	3	4	119				109	104	100	94	90	84	78	65	51								
TPV 6x12/5.5	32x32	4	5.5	159				145	139	133	125	120	113	104	87	68								
TPV 6x16/7.5	32x32	5.5	7.5	197				180	173	165	156	150	140	130	108	85								
TPV 8x4/2	40x40	1.5	2	53						44	42	41	39	37	33	29	23	17	12					
TPV 8x6/3	40x40	2.2	3	79						66	64	61	59	56	50	44	35	26	18					
TPV 8x8/4	40x40	3	4	105						88	85	82	78	74	66	58	46	34	24					
TPV 8x10/5.5	40x40	4	5.5	132						110	106	102	98	93	83	73	58	43	30					
TPV 8x13/7.5	40x40	5.5	7.5	171						143	138	133	127	121	108	95	75	56	39					
TPV 8x17/10	40x40	7.5	10	224						187	180	173	167	158	141	124	99	73	51					
TPV 12x3/2	50x50	1.5	2	44								43	42	41	40	38	36	33	30	27	24	20	17	
TPV 12x4/3	50x50	2.2	3	59								58	57	55	53	50	48	44	40	36	32	27	23	
TPV 12x5/4	50x50	3	4	73								72	71	69	66	63	60	55	50	45	40	34	29	
TPV 12x7/5.5	50x50	4	5.5	102								101	99	97	92	88	84	77	70	63	56	48	40	
TPV 12x9/7.5	50x50	5.5	7.5	132								130	127	124	119	113	108	99	90	81	71	61	51	
TPV 12x11/10	50x50	7.5	10	161								159	155	152	145	138	131	121	110	99	87	75	63	
TPV 12x15/15	50x50	11	15	220								217	212	207	198	189	179	165	150	136	119	102	86	

MODEL	DN mm	Power kw hp		Q=DELIVERY									
				us gpm	26	53	79	106	132	159	185	211	
				l/min	100	200	300	400	500	600	700	800	
				m ³ /h	6	12	18	24	30	36	42	48	
					H=Head (m)								
TPV 30x5/10	65x65	7.5	10	105	100	93	86	78	67	54	36	4	
TPV 30x6/12	65x65	9.2	12.5	126	120	112	103	94	80	65	44	5	
TPV 30x8/15	65x65	11	15	168	158	149	138	124	106	86	58	6	

Material

- Casing: Grey cast iron
- Impeller: Plastic
- Shaft: Stainless Steel 304
- Shaft Seal: Mechanical seal

MATERIAL DESCRIPTION

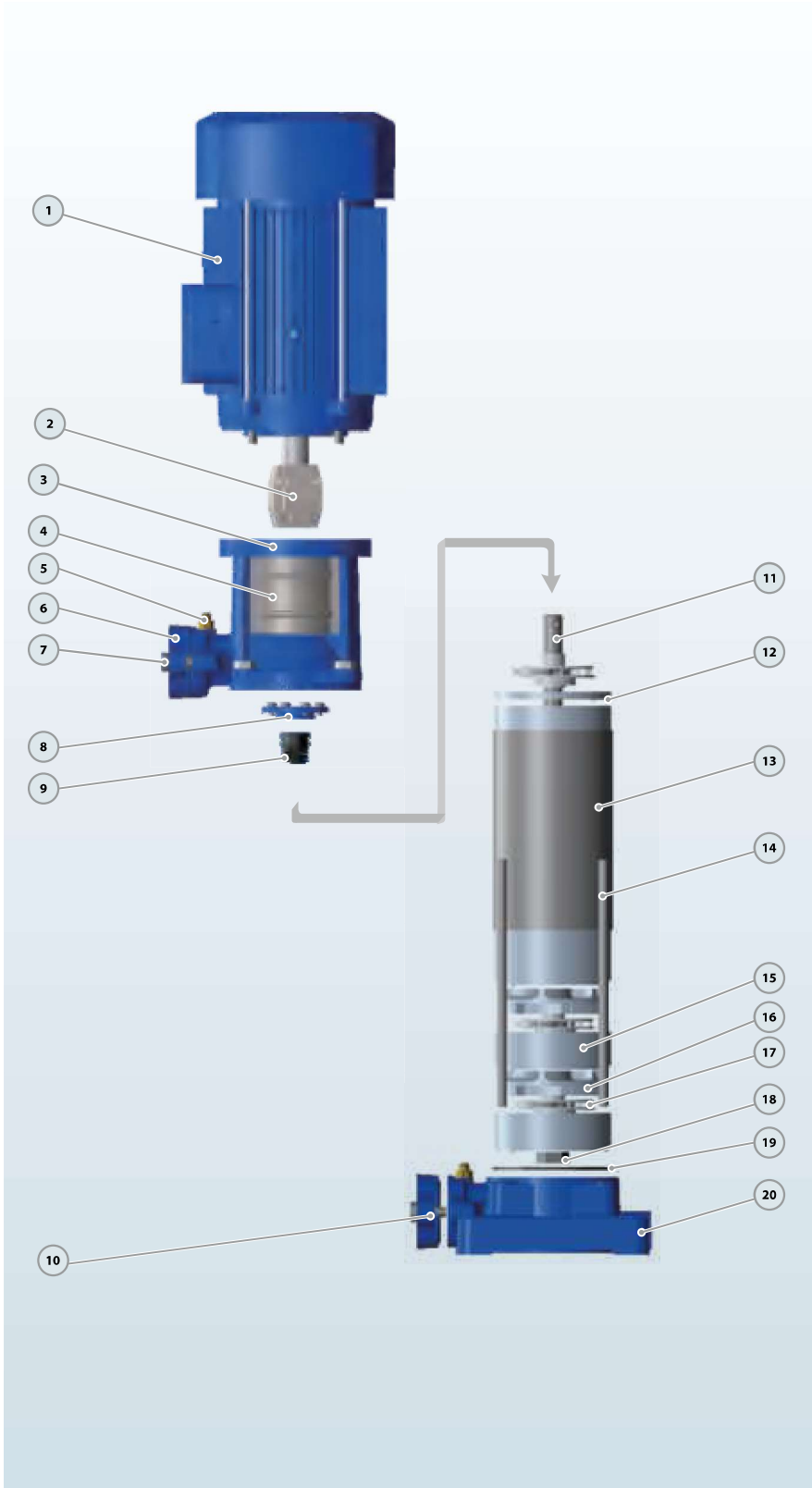

No.	Description	Material
1	Motor	IP55 / Class F
2	Coupling	Iron
3	Discharge Body	Cast iron
4	Cover	SS304
5	Release Valve	Brass
6	Discharge	Cast iron
7	Bolt	Steel
8	Seal Cover	Cast iron
9	Mechanical Seal	SiC/Carbon/SS304
10	Suction	Cast iron
11	Pump Shaft	SS304
12	Diffuser Top Cover	Techno-polymer
13	Pump Cover	SS304
14	Through Bolt	Steel
15	Diffuser Cover	Techno-polymer with SS304 ring
16	Diffuser	Techno-polymer with SS304 ring
17	Impeller	Techno-polymer
18	Impeller Nut	Galvanized Steel
19	O-ring	Rubber
20	Suction Body	Cast iron

DIMENSIONS & WEIGHT

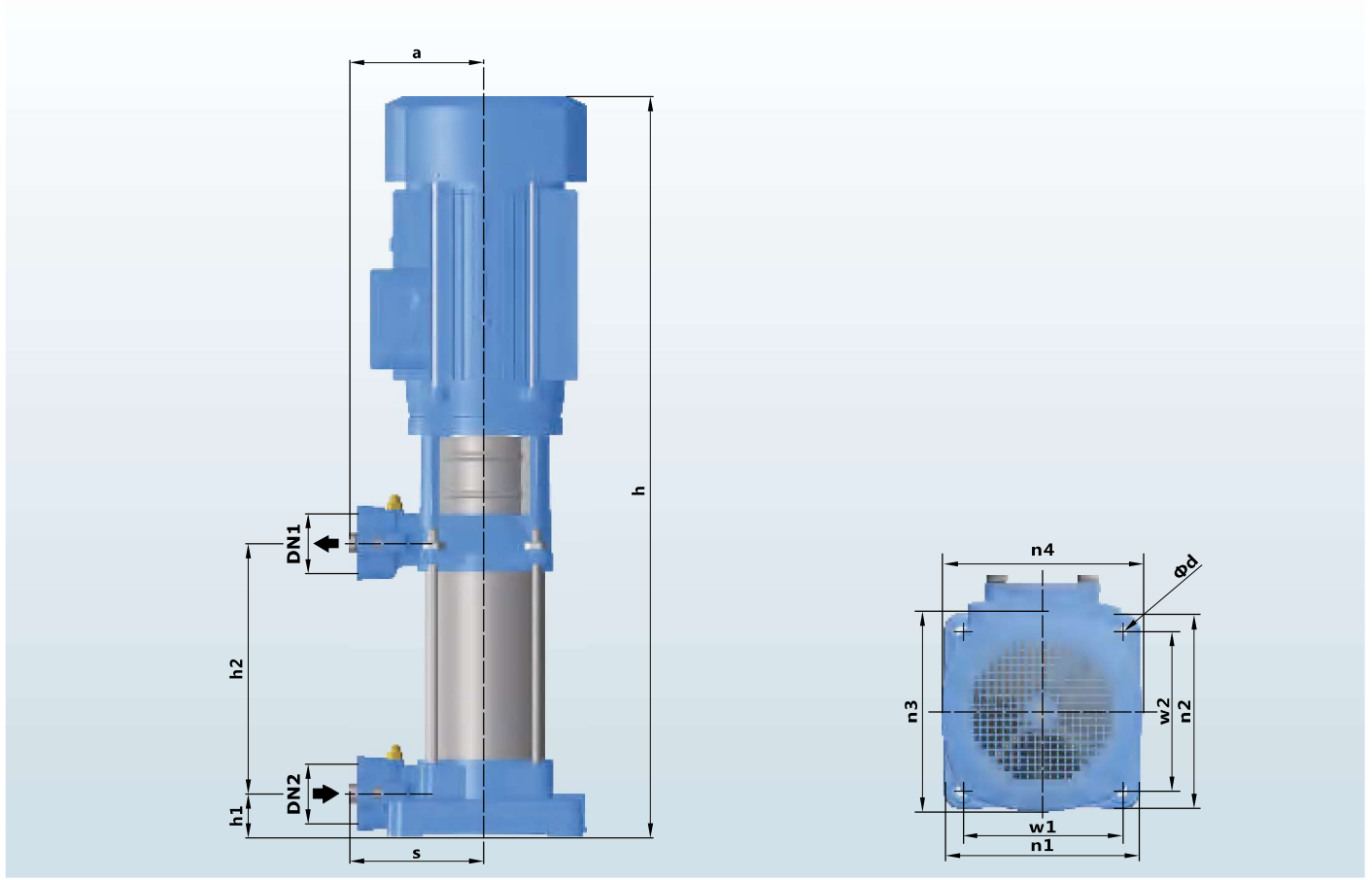

MODEL		DIMENSIONS (mm)															kg	
Single-phase	Three-phase	DN1	DN2	N	a	s	h	h1	h2	w1	w2	n1	n2	n3	n4	d	1~	3~
TPV 4x4/1.5	TPV 4x4/1.5	25/32	25/32	4	141	141	615.5	45.5	156.5	165	165	202	202	175	175	12	27.0	26.0
TPV 4x6/2	TPV 4x6/2	25/32	25/32	6	141	141	685.5	45.5	226.5	165	165	202	202	175	175	12	32.0	31.0
TPV 4x8/3	TPV 4x8/3	25/32	25/32	8	141	141	755.5	45.5	296.5	165	165	202	202	175	175	12	37.0	36.0
TPV 4x10/4	TPV 4x10/4	25/32	25/32	10	141	141	822.5	45.5	366.5	165	165	202	202	195	195	12	47.0	46.0
-	TPV 4x13/5.5	25/32	25/32	13	141	141	977.5	45.5	471.5	165	165	202	202	195	195	12	-	51.0
-	TPV 4x16/7.5	25/32	25/32	16	141	141	1132.5	45.5	576.5	165	165	202	202	204	204	12	-	61.0
TPV 6x3/1.5	TPV 6x3/1.5	25/32	25/32	3	141	141	580.5	45.5	121.5	165	165	202	202	175	175	12	26.0	25.0
TPV 6x5/2	TPV 6x5/2	25/32	25/32	5	141	141	650.5	45.5	191.5	165	165	202	202	175	175	12	31.0	30.0
TPV 6x7/3	TPV 6x7/3	25/32	25/32	7	141	141	720.5	45.5	261.5	165	165	202	202	175	175	12	36.0	35.0
TPV 6x9/4	TPV 6x9/4	25/32	25/32	9	141	141	837.5	45.5	331.5	165	165	202	202	195	195	12	46.0	45.0
-	TPV 6x12/5.5	25/32	25/32	12	141	141	942.5	45.5	436.5	165	165	202	202	195	195	12	-	50.0
-	TPV 6x16/7.5	25/32	25/32	16	141	141	1132.5	45.5	576.5	165	165	202	202	204	204	12	-	60.0
TPV 8x4/2	TPV 8x4/2	40/50	40/50	4	141	141	615.5	45.5	156.5	165	165	202	202	175	175	12	30.0	29.0
TPV 8x6/3	TPV 8x6/3	40/50	40/50	6	141	141	685.5	45.5	226.5	165	165	202	202	175	175	12	35.0	34.0
TPV 8x8/4	TPV 8x8/4	40/50	40/50	8	141	141	802.5	45.5	296.5	165	165	202	202	195	195	12	45.0	44.0
-	TPV 8x10/5.5	40/50	40/50	10	141	141	872.5	45.5	366.5	165	165	202	202	195	195	12	-	49.0
-	TPV 8x13/7.5	40/50	40/50	13	141	141	1027.5	45.5	471.5	165	165	202	202	204	204	12	-	59.0
-	TPV 8x17/10	40/50	40/50	17	141	141	1167.5	45.5	611.5	165	165	202	202	204	204	12	-	64.0
TPV 12x3/2	TPV 12x3/2	40/50	40/50	3	141	141	580.5	45.5	121.5	165	165	202	202	175	175	12	28.0	27.0
TPV 12x4/3	TPV 12x4/3	40/50	40/50	4	141	141	615.5	45.5	156.5	165	165	202	202	175	175	12	33.0	32.0
TPV 12x5/4	TPV 12x5/4	40/50	40/50	5	141	141	697.5	45.5	191.5	165	165	202	202	195	195	12	41.0	40.0
-	TPV 12x7/5.5	40/50	40/50	7	141	141	767.5	45.5	261.5	165	165	202	202	195	195	12	-	45.0
-	TPV 12x9/7.5	40/50	40/50	9	141	141	887.5	45.5	331.5	165	165	202	202	204	204	12	-	55.0
-	TPV 12x11/10	40/50	40/50	11	141	141	957.5	45.5	401.5	165	165	202	202	204	204	12	-	62.0
-	TPV 12x15/15	40/50	40/50	15	141	141	1127.5	45.5	541.5	165	165	202	202	260	260	12	-	80.0
-	TPV 30x5/10	50/65	50/65	5	170	170	939	62	309	187	187	230	230	260	260	12	-	84.0
-	TPV 30x6/12	50/65	50/65	6	170	170	993	62	362.5	187	187	230	230	260	260	12	-	90.0
-	TPV 30x8/15	50/65	50/65	8	170	170	1100	62	469.5	187	187	230	230	260	260	12	-	97.0

PERFORMANCE CURVES

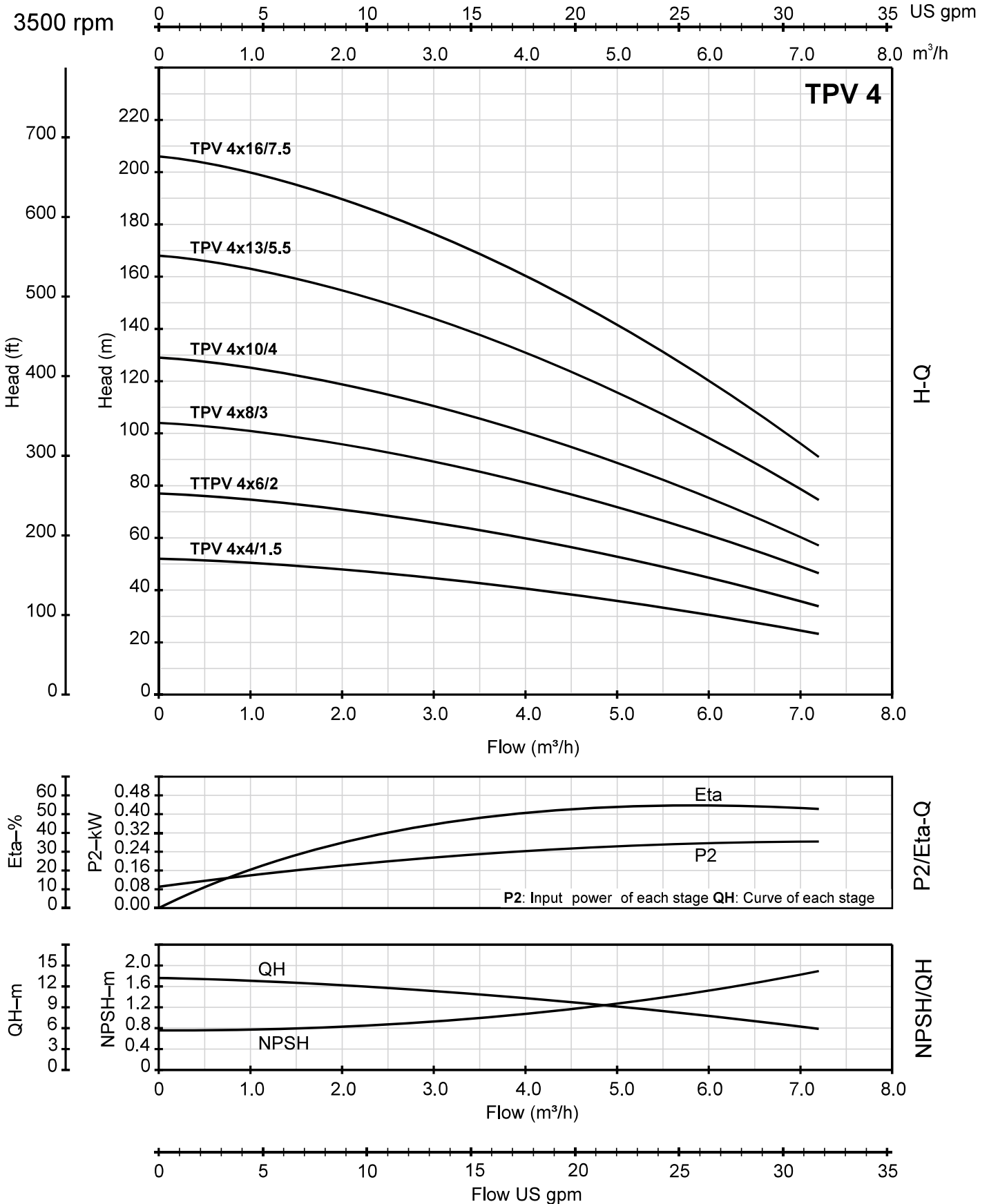

PERFORMANCE CURVES

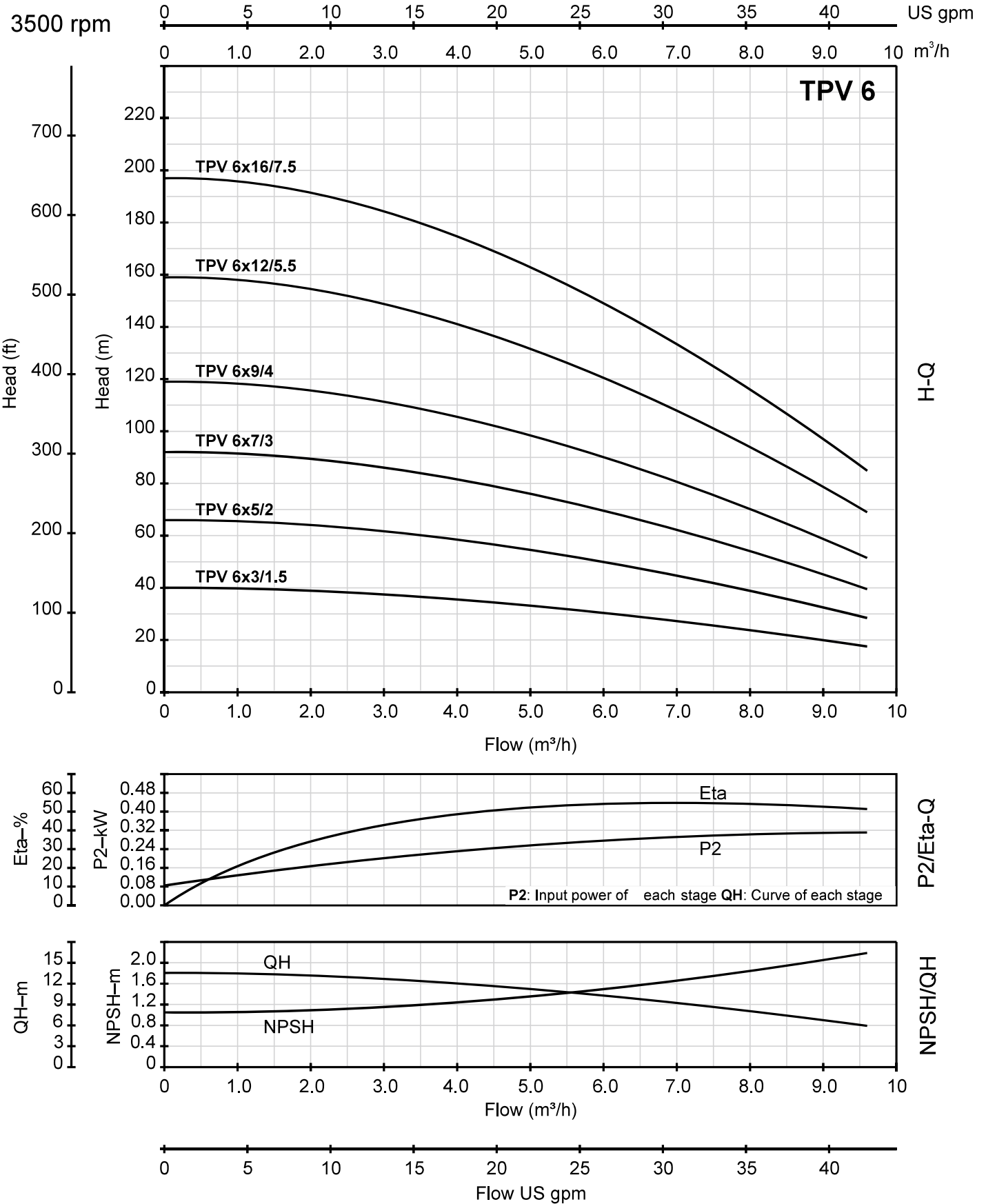

PERFORMANCE CURVES

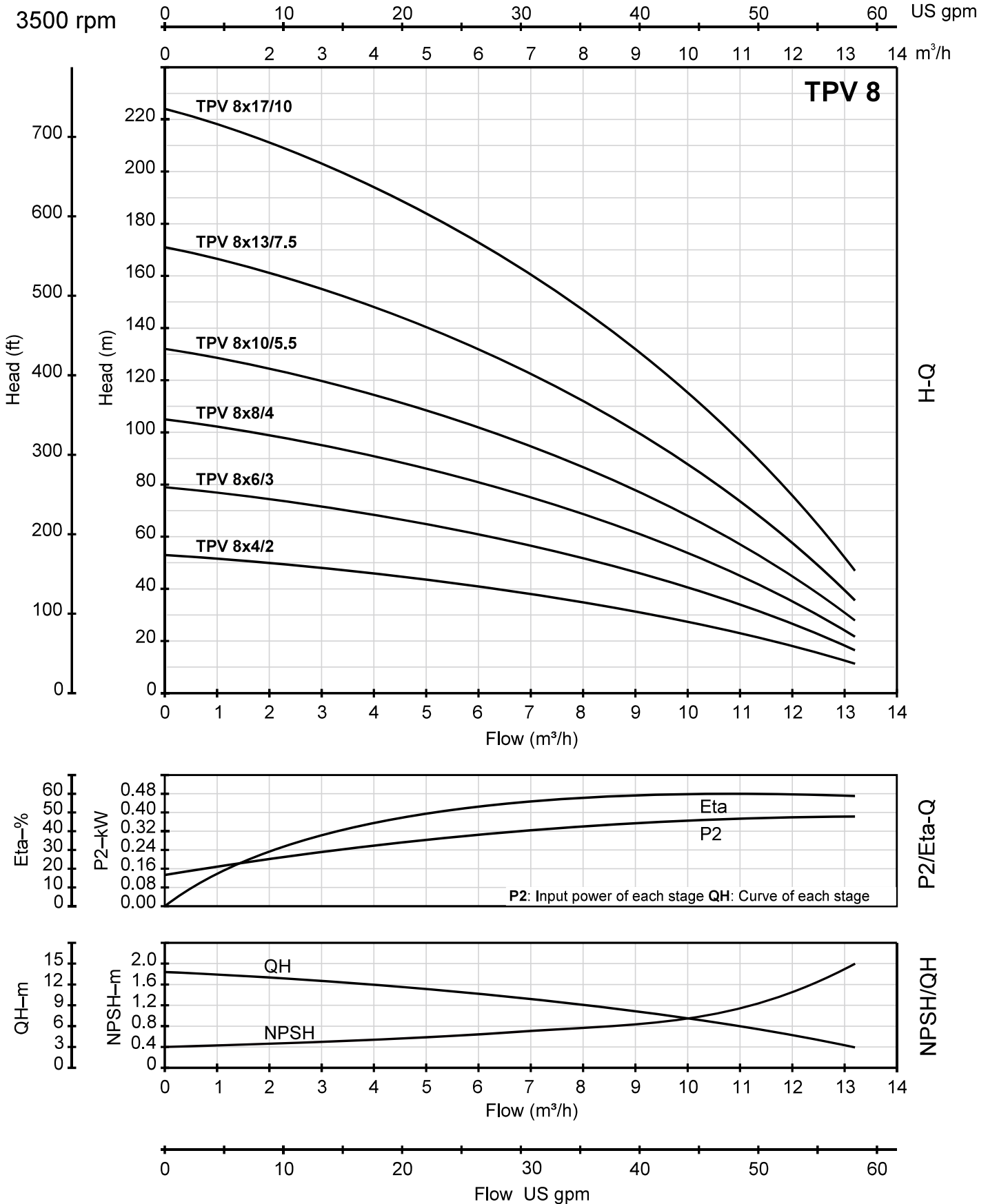

PERFORMANCE CURVES

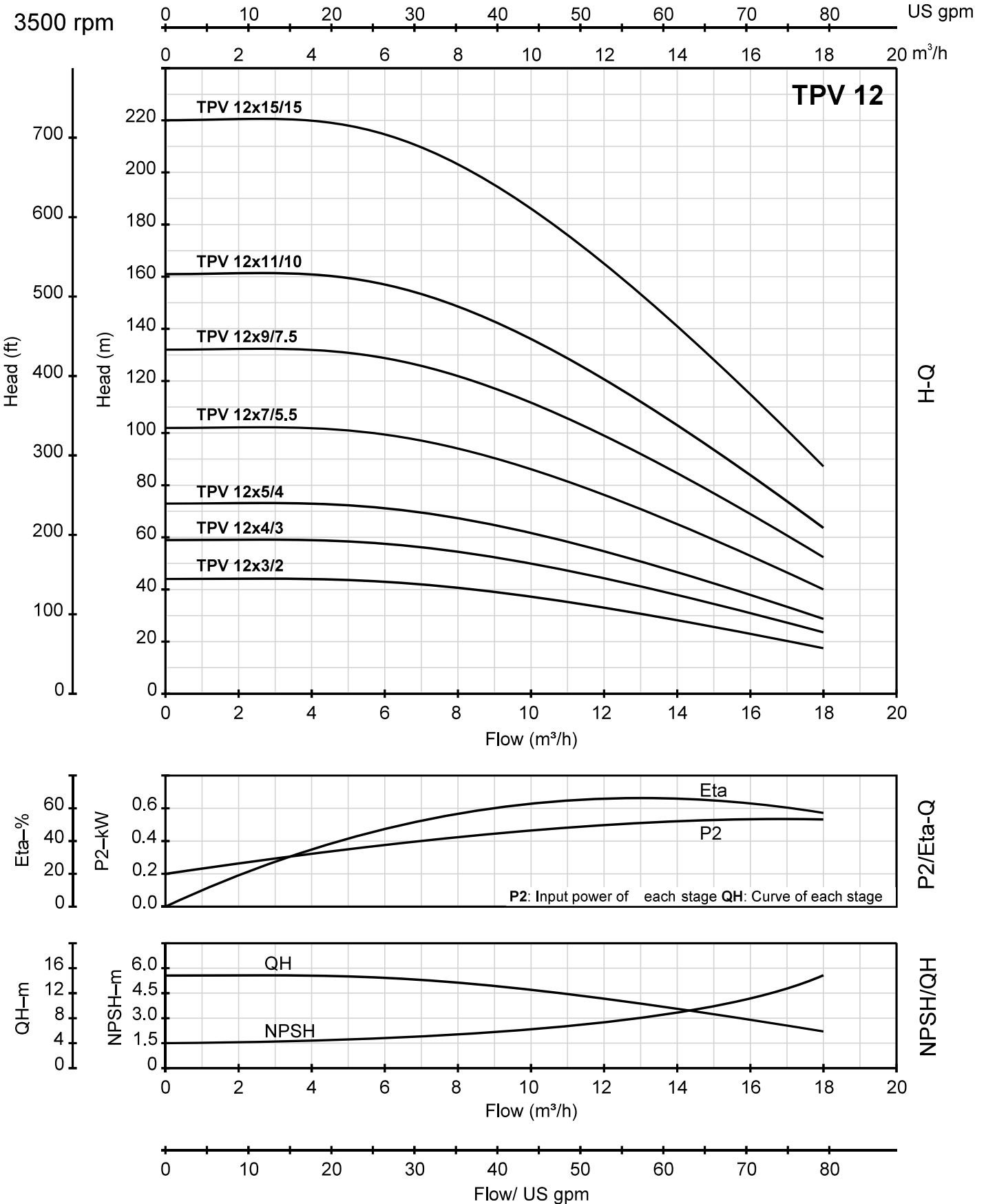

PERFORMANCE CURVES

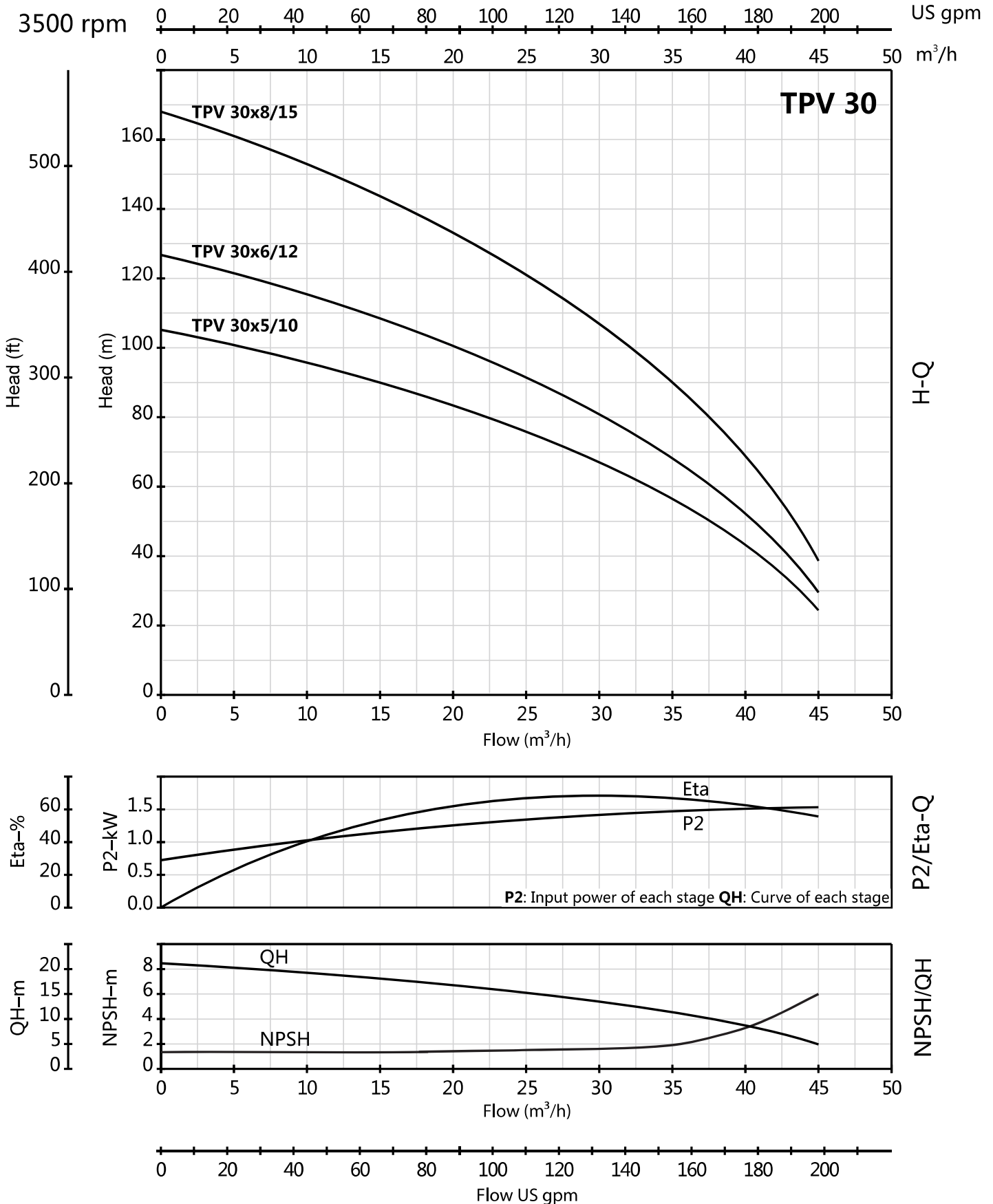

MEMO

.....
.....
.....
.....
.....
.....
.....
.....
.....
.....
.....
.....
.....
.....
.....
.....
.....
.....
.....
.....
.....
.....
.....
.....
.....
.....
.....
.....
.....
.....
.....
.....
.....
.....
.....
.....
.....
.....
.....
.....
.....
.....
.....
.....
.....
.....
.....
.....
.....
.....
.....
.....
.....
.....

TECNODYNE

TECNODYNE PUMPS INC.

02 Sheppard Ave E, North York
Ontario, Canada M2N 5Y7
T: +1 (438) 308-2072
info@tecnodyne.ca
www.tecnodyne.ca