

## TPD Series

# TPD 25-4S Circulation Pumps 50Hz

PRODUCT CATALOGUE



# CIRCULATION PUMPS

## Efficient & Reliable

### Series Description

The pump contains two parts: a hydraulic section and a motor (with a wet rotor). The hydraulic section contains a pump housing, and impeller while the motor includes a stator, rotor, cartridge, and air-venting nut. The pump does not use a mechanical seal. The stator and rotor are sealed with a cartridge made of stainless steel and two heat-resistant rubber rings, which ensure no leakage. Lubrication of bearings and cooling of the motor by the inner circulation of the pumped liquid. It can be used in single pipe or double pipe heating system. It also can be used in apartments, villas, cooling, air-conditioning, boilers and solar systems etc.

### Application

- Hot water circulation for all heating systems.
- Industrial circulation systems.
- HVAC systems.
- Chilled water systems

### Materials

Pump housing: Cast Iron/Bronze/Stainless steel

Impeller: Plastic

Shaft: Ceramic / Stainless steel

Bearing Base: Stainless steel

Bearing: Ceramic/ Baptist antimony graphite

Connection: Cast iron / Bronze / Stainless steel

Pump with Cast iron housing is widely used for delivering water for room heating. Pump with Bronze housing is largely used in the floor heating system.



### Model Description

**TPD 25 - 4 S B / 130**

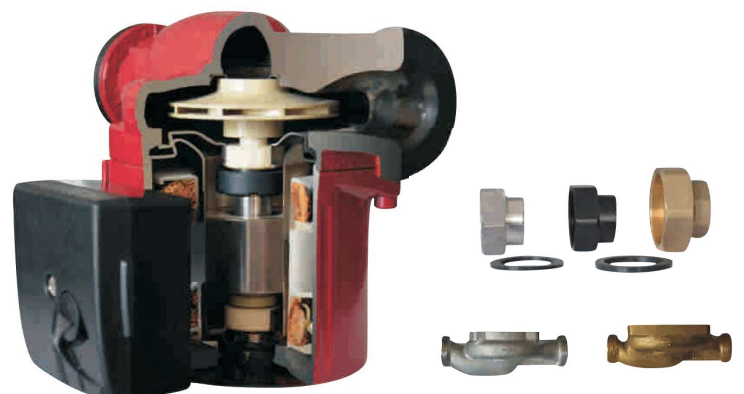
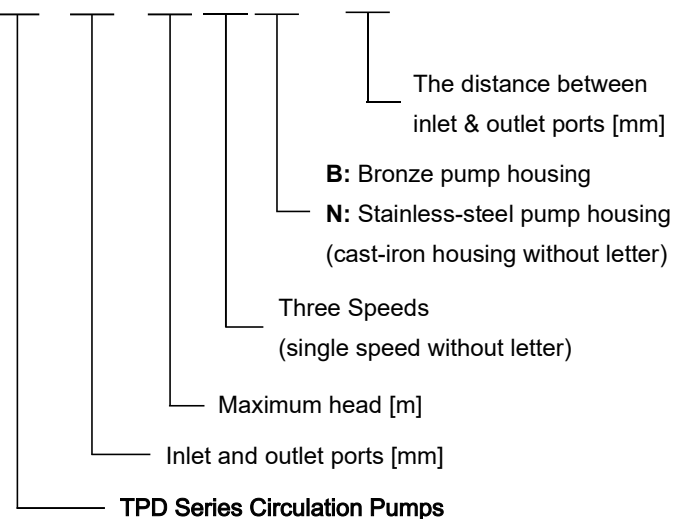

# PRODUCT OVERVIEW

## TPD 25-4S

### Operating Data

- Medium: thin, clean, non-corrosive and non-explosive liquid, does not contain any solid particles, fibers or mineral oil.
- Maximum system pressure: 1.0 MPa.
- Min / Max medium temperature: 2 ~ 110 °C
- Min / Max. ambient temperature: 0 ~ 40 °C

In order to avoid condensed water in stator, make sure the ambient temperature is lower than liquid temperature.

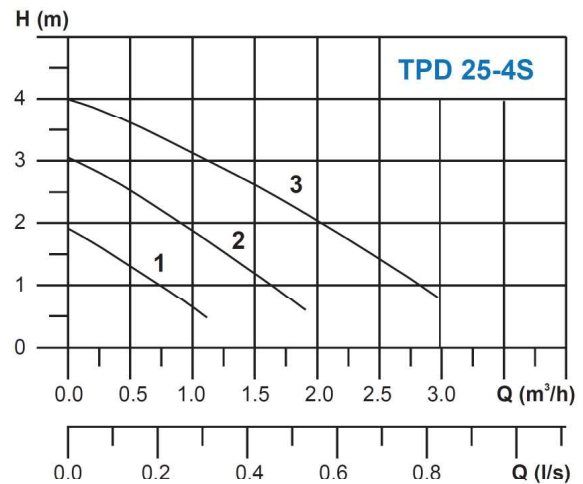

### Motor

- Insulation Class: H
- Protection Class: IP44
- Motor fixed with thermal protector
- Single speed or three speeds.
- Power: 1ph x 230V / 50Hz

### Features

- Low noise operation.
- No leakage.
- Ecological safety in operation.
- Easy installation and reliable operation.

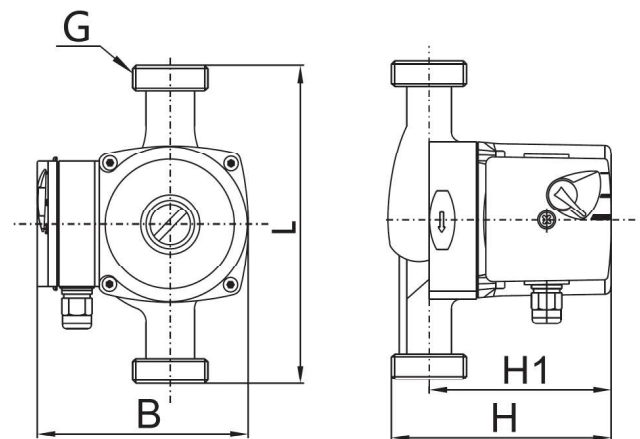

Model	Max. Flow [m³/h]	Max. Head [m]	Rated Power [W]	Rated Current [A]	Power Input / Output [W]	Voltage (V)	Pump Housing Material
TPD 25-4S	3.0	4.0	65 / 50 / 32	0.28 / 0.22 / 0.15	65 / 20	230	Cast Iron / Bronze / Stainless Steel

### Dimensions & Weight

Model	Dimension [mm]					Weight [Kg]		Volume [m³]	Connec-tion / Flange	Package size [mm]	
	L	H	H1	B	G	N.W	G.W			Inner box	Outer box
TPD 25-4S	130 180	130	105	130	1½"	2.4	3.0	0.0041	1½" - 1"	170×140×145 200×140×145	350×290×300 410×290×300

# TECNODYNE

## **TECNODYNE PUMPS INC.**

02 Sheppard Ave E, North York  
Ontario, Canada M2N 5Y7  
T: +1 (647) 255-2270  
[info@tecnodyne.ca](mailto:info@tecnodyne.ca)  
[www.tecnodyne.ca](http://www.tecnodyne.ca)

## **TECNODYNE (China) Ltd.**

Suite C, Level 7, World Trust Tower  
50 Stanley Street, Central  
Hong Kong  
[hk@tecnodynepumps.com](mailto:hk@tecnodynepumps.com)  
[www.tecnodynepumps.com](http://www.tecnodynepumps.com)